

Volumes of versatility

Capture large volumes of documents without delay

FUJITSU Image Scanner fi-5950

- **Productive.** Benefit from impressive speed and superior paper handling
- **Tough.** Powerful, high-end performer to reliably process large volumes of documents
- **Intuitive.** High end features and performance yet with impressive ease of use
- **Economic.** See a fast Return On Investment (ROI) and impressively low Total Cost of Ownership (TCO)



shaping tomorrow with you

FUJITSU

Satisfy the highest demands for image quality and throughput everyday with consummate ease



The FUJITSU Image Scanner fi-5950 production scanner is the paper-to-digital highway that minimises human interaction with dependable pre to post scan automation. Excellent sheet handling functions and reliable paper processing performance support continuous and efficient mixed batch processing. Operators can incorporate the advanced image enhancement functions and experience high speed processing – essential for productive batch scanning. Fujitsu image enhancement, paper processing and automated procedures result in measurable business advantages when used for production and ad hoc image capture and high-volume archiving.

- Capture documents and integrate with business processes
- Boost throughput by minimising unwanted interruptions
- Satisfy compliance, business continuity and other requirements with confidence
- Handle large volumes of documents of varying paper sizes, colours and thicknesses
- Minimise downtime with Scanner Central Admin, field-replaceable consumables and easy maintenance



Integrated operating panel

High-speed efficiency

When faced with large daily demands, document capture bureaus and busy departments can respond with streamlined efficiency. At up to 135 (A4 landscape) pages per minute (ppm) or 270 images per minute (ipm) at 300 dpi resolution and an array of powerful image enhancing and paper-feed functions the fi-5950 can shrink the operator's workload before, during and after scanning.

The Intelligent Multifeed Function allows document scan parameters to be applied which enables the sensors to be set up to help identify and subsequently ignore attachments such as sticky notes or items with a photo attached that would otherwise cause disruptions to the scanning process. Automatic Paper Size and Automatic Colour Detection functions enable batches of documents containing sheets of different sizes and colour backgrounds to be captured as high quality images without having to arrange them into an ordered sequence beforehand.



A4 Landscape at 300 dpi 135 ppm / 270 ipm
A4 Portrait at 300 dpi 105 ppm / 210 ipm
Scan mixed batches through the 500 sheet hopper

Seamless hopper-to-stacker function

Document flow from the adjustable 500 page ADF feeder tray to a 100% flat scanning zone and active stacking tray operates as a smooth action and this combined with ultrasonic sensor detection helps protect original documents if a feeding error occurs.

High quality turnaround every day

Reliability, versatility and fast scanning speeds combine with factors such as impressive start-up times and automated functions to provide owners with end-to-end fast turnaround. High speed CCD camera technology produces consistently high quality images for satisfying regulatory compliance standards.

Powerful software for automated productivity

The fi-5950 includes powerful PaperStream IP and PaperStream Capture software. Operators can produce optimised images for different types of documents and import them into workflows. Scanning profiles are easily created according to scanning requirements.

Functionalities such as OCR, multi-streaming options and a wealth of output formats including password protected PDF and PDF/A formats all support improved efficiency. An ability to set up job routine profiles that can be easily exported and imported from other scanners provides ease of use and batch scanning can be streamlined with bar code and patch code job separation functionality which also helps with effective archiving.



Fast Return On Investment (ROI)

The fi-5950 scanning solution helps contribute towards productivity improvements within a bureau, department or business thereby minimising the overall cost of ownership. A fast ROI can be realised by the fi-5950's low acquisition cost, robust manufacture, a daily duty cycle of 100,000 sheets and operator exchangeable consumables that are highly durable. Operational alerts and Scanner Central Admin software enable Fujitsu scanners to be managed and maintained from a single location to minimise scanner downtime anywhere on the global system.

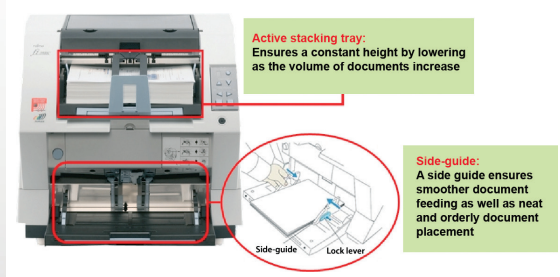

Optional extras

Pre Imprinter (fi-590PRF) {Part Number – PA03450-D700}

Post Imprinter (fi-590PRB) {Part Number – PA03450-D710}

The imprinter options enable users to print on the front or reserve sides of the information on original documents for document management purposes before (front) or after scanning (reverse side) for reasons such as compliance. The imprinter can serve as proof of capture and as a cross reference when combined with a virtual imprint on the digitised image.

CGA board (fi-595CGA) {Part Number – PA03450-K171}

This CGA board option with VRS Professional offers further image enhancement possibilities.



Fujitsu developed best in class scanner driver and image capturing / processing software



PaperStream IP – high quality image enhancement

PaperStream IP is the scanner driver for the fi-5950 scanner. In addition to being fully compliant with the industry standard TWAIN and ISIS interface, PaperStream IP incorporates as standard, highly sophisticated image processing that automatically applies features such as noise removal, background pattern removal and character augmentation to produce exceptionally clear, high quality images that are suitable for direct import into the users' workflow.

PaperStream IP has an intuitive, easy to use interface that can be switched between Administrator or User mode to simplify the scanning process and reduce user error.

Additionally PaperStream IP also introduces a new Assisted Scanning mode, which allows the user to visually select the best quality image from a range of images of the page, rather than needing to manually fine tune the scanning parameters one by one.



PaperStream Capture – enhanced capture

PaperStream Capture is an easy to use capture tool which allows users to easily create scanning routines which encapsulate all of the settings and configuration required to control the scanning process from scan to the release of the image to the users' or companies' defined workflow.

Once created, profiles can be run by a single click and the most frequently used profiles can even be linked to the fi-5950 scanner front panel scan button to streamline the whole capture process.

Specifications

Model	fi-5950
Supported operating systems	See http://emea.fujitsu.com/fiscannerfaqs/ for further information
Scanner type	ADF (automatic document feeder) and manual feed
Scanning modes	Simplex / Duplex, Colour / Greyscale / Mono
Imaging sensor type	Colour CCD (charge coupled device) x 2
Light source	White cold cathode discharge lamp x 4
Document size	Minimum: A8 Portrait 52 x 74 mm / Maximum: A3 (297 x 420 mm) Long page scanning: 3,048 mm ¹
Recommended paper weight	31 to 209 g/m ²
Scanning speed (A4 Landscape) ²	Simplex: 135 ppm (200, 300 dpi), Duplex: 270 ipm (200, 300 dpi)
Scanning speed (A4 Portrait) ²	Simplex: 105 ppm (200, 300 dpi), Duplex: 210 ipm (200, 300 dpi)
Paper chute capacity ⁴	500 sheets (A4: 80 g/m ²)
Background colours	White / Black (Selectable)
Optical resolution	600 dpi
Output resolution ⁵	50 to 600 dpi (adjust by 1 dpi increments) 1,200 dpi (driver) ⁶
Output format	Colour: 24 bit, Greyscale: 8 bit, Mono: 1 bit
Interface ⁷ / Connector shape	Ultra Wide SCSI, USB 2.0, USB 1.1 (Selectable) / Ultra Wide SCSI: Shield type 68 pin (pin type), USB: B type
Image processing functions	Automatic colour detection, Automatic page size detection, De-Skew, Automatic orientation, Upper lower separation, Multi-image, Blank page skip, Error diffusion, Dither, Dropout colour (R, G, B, None, White, Specified, Saturation), Image emphasis, Simplified DTC, Advanced DTC, iDTC, sRGB
Power requirements	AC 100 to 240V, ±10%
Power consumption	Operating: 250W or less (Sleep mode: 3.2W or less) Auto Standby (OFF) mode: 0.5W or less
Operating environment	Temperature: 15° to 35°C, Relative humidity: 20 to 80% (Non-condensing)
Dimensions (W x D x H) ⁸ / Weight	540 x 540 x 500 mm / 50 kg
Included software / drivers	PaperStream IP Driver (TWAIN & ISIS™), 2D Barcode for PaperStream, Software Operation Panel, Error Recovery Guide, PaperStream Capture, Scanner Central Admin tools
Environmental compliance	ENERGY STAR® / RoHS ⁹ / Ecodesign ¹⁰
Others	Double-feed detection 3 ultrasonic double-feed detection sensors

¹ The fi-5950 is capable of scanning documents that exceed A3 in length: Documents up to 863 mm in length can be scanned at resolutions up to 400 dpi and documents between 863 mm and 3,048 mm can be scanned at resolutions between 50 dpi and 200 dpi (Long paper scanning does not support resolutions that exceed 400 dpi).

² Actual scanning speeds are affected by data transmission and software processing times.

³ JPEG compressed figures.

⁴ Maximum capacity varies, depending upon paper weight.

⁵ Maximum output resolutions may vary, depending upon the size of the area being scanned and whether the scanner is scanning in simplex or duplex.

⁶ Scanning limitations due to scanning mode, document size and available memory may occur when scanning at high resolutions (600 dpi or higher).

⁷ Ultra Wide SCSI interface cannot be used simultaneously with USB 2.0.

⁸ Excluding the ADF hopper and stacker.

⁹ PFU LIMITED, a Fujitsu company, has determined that this product meets RoHS requirements (2011/65/EU)

¹⁰ PFU LIMITED, a Fujitsu company, has determined that this product meets Ecodesign Directive requirements (2009/125/EC)

All names, manufacturer names, brand and product designations are subject to special trademark rights and are manufacturer's trademarks and/or registered brands of their respective owners.
All indications are non-binding. Technical data is subject to change without prior notification.



PFU (EMEA) Limited
Hayes Park Central
Hayes End Road, Hayes
Middlesex UB4 8FE
United Kingdom

Tel: +44 (0)20 8573 4444

PFU (EMEA) Limited
Frankfurter Ring 211
80807 Munich
Germany

Tel: +49 (0)89 32378 0

PFU (EMEA) Limited
Viale Monza, 259
20126 Milano (MI)
Italy

Tel: +39 02 26294 1

PFU (EMEA) Limited
Camino Cerro de los Gamos, 1
28224 Pozuelo de Alarcón
Madrid
Spain

Tel: +34 91 784 90 00

<http://emea.fujitsu.com/scanners>

FUJITSU