

Self Cleaning Functions

Ionizer NEW

The ion-filled breeze created by the ionizer neutralizes the electrical charge on the documents to be scanned, and reduces the amount of paper dust that clings to their surface. This ion-filled breeze also flows through the paper path and removes paper dust from the scanning glass to reduce the need for the user to clean the glass.

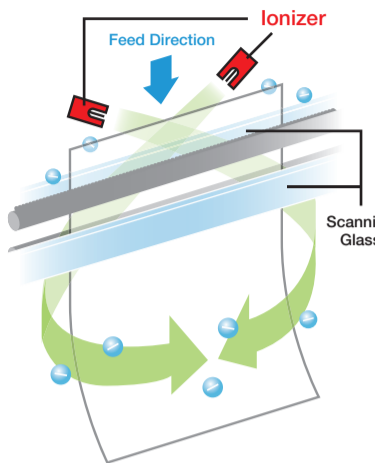

Scanning Glass Cleaning Brush NEW

The brush directly cleans the scanning glass to further prevent paper dust. This eliminates the need for maintenance and ensures comfortable scanning operations.

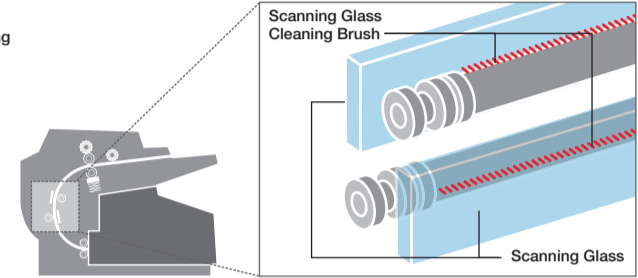

High-Reliability Scanning

Mixed Document Feeding

Accurately Feeds Various Sized Documents

Documents with different sizes and thicknesses can all be fed together. They can be set in center, left, or right alignment. By using left or right single-side alignment, there is no more need to spend time organizing documents according to their size, so scanning is fast and easy. This function greatly increases work efficiency.

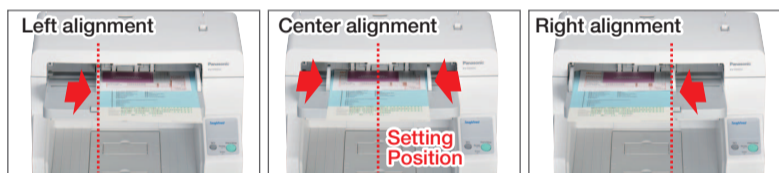

The scanner feeds accurately, regardless of alignment.

Long Paper Mode

High-Speed Scanning of Sheets up to 100 feet Long

The highly reliable paper feed mechanism quickly and stably scans long documents. This function boosts work efficiency by smoothly scanning long documents like continuous business forms or electrocardiograms.

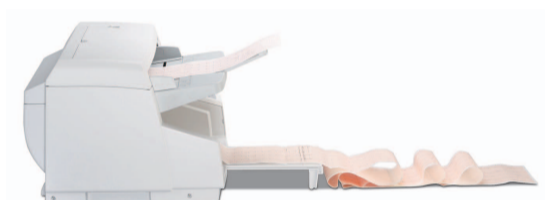

Pre-Imprinter

Raises filing efficiency

The pre-imprinter prints text (date and/or number) onto the surface of a document before its image is scanned, so the text data is included in the scanned image data. This improves filing efficiency.

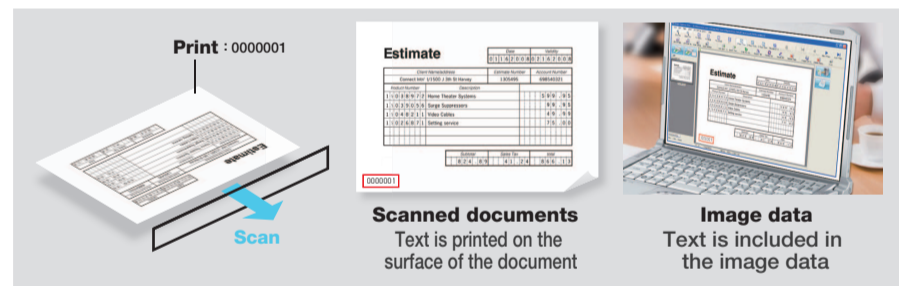

Optional Flatbed Scanner

Single User Interface

Easily Scan Documents and Booklets

By selectively using the KV-S5055C and the optional KV-SS080,* you can easily scan documents and booklets, and save them in the same document.

*To operate the KV-SS080, the KV-S5055C is required. The KV-SS080 does not operate as a standalone unit.

Multi-Crop

Save Time by Reducing the Number of Scans

Place various sized documents on the flatbed and scan them all at once, then crop whatever parts you need. This is convenient for scanning multiple business cards and thick documents.

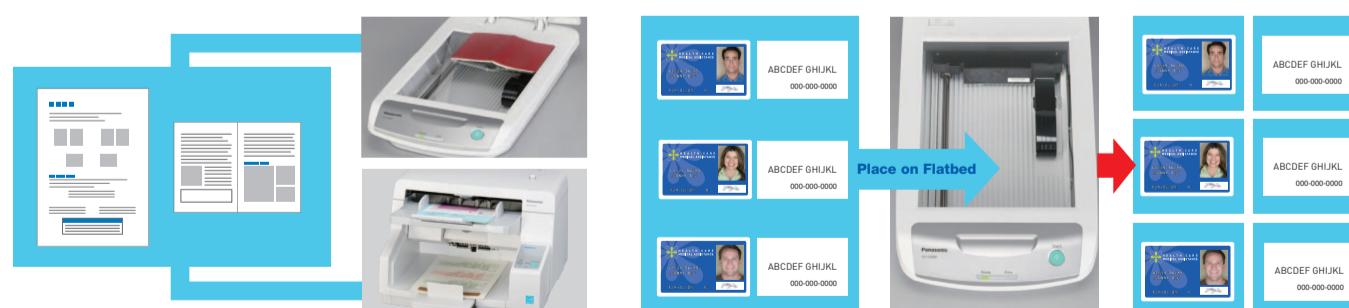

Easy Maintenance

The clamshell design allows full, easy access to the entire paper path, so you can clear paper jams, clean the unit, or replace a roller easily without having to call a service technician.

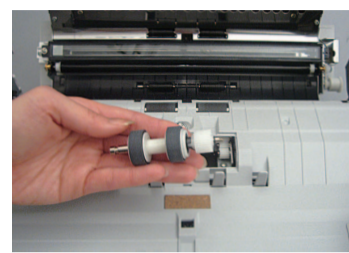

Rollers are easy to replace.

High-Volume ADF

The ADF (Automatic Document Feeder) holds up to 200 sheets of paper to allow continuous scanning of large document runs.



KV-S5055C Specifications

Scanning Face	Duplex
Scanning Method	Front side: CCD (600 dpi) Back side: CCD (600 dpi) Selectable black and white background reference
Scanning Speed**	Binary / Color Letter size 200 dpi Simplex Up to 75 ppm (Portrait) Up to 90 ppm (Landscape)
	Duplex Up to 150 ppm (Portrait) Up to 180 ppm (Landscape)
	Binary / Color Letter size 300 dpi Simplex Up to 50 ppm (Portrait) Up to 60 ppm (Landscape)
	Duplex Up to 100 ppm (Portrait) Up to 120 ppm (Landscape)
Resolution	100 - 600 dpi (1 dpi step), Optical 600 dpi (Main and Sub feeding directions)
Detection	Ultrasonic double feed detection (1 position), Stapled document detection
Compression	JPEG 100% grayscale
Tonal Gradation	Binary, Grayscale (8 bit), Color, MultiStream - Binary & Grayscale, Binary & Color
Binary Mode HalfTone	Dither, Error diffusion
Image Control	Image emphasis, Dynamic threshold, Automatic separation, Invert, White level from paper
Other Functions	Length control, Barcode detection (SIS), Patch code detection, Automatic separation, Control sheet, Long paper mode
Maximum Image Size	12.01 x 100 in. (305 x 2,540 mm)
Documents**	Size Minimum 1.9 x 2.75 in. (48 x 70 mm) Maximum 17.7 x 17 in. (267 x 432 mm)
	Thickness 1.6 - 7.9 mils (0.04 - 0.2 mm) Note: 1 mil = 0.001 in.
	Weight 5 - 42 lbs. (20 - 157 g/m ²)
Hopper Capacity	Up to 200 sheets (75 g/m ² , 20 lbs.) New paper
Image Memory	Standard 32 MB Maximum Base memory plus 1 GB
Supported Operating System	Windows® XP, Windows Vista®, Windows® 7
Interface	USB 2.0
Power Requirement	AC 100 - 120 V, 50/60 Hz AC 220 - 240 V, 50/60 Hz
Power Consumption	Maximum (Scanning) 1.8 A (100 - 120 V), 0.5 A (220 - 240 V)
	Minimum (Standby) 0.4 A (100 - 120 V), 0.2 A (220 - 240 V)
	Sleep mode 3.5 W or less (100 - 120 V, 220 - 240 V)
Operating Environment	Temperature 59 - 86 °F (15 - 30 °C) Humidity 20 - 80 % RH
Storage Environment	Temperature 32 - 104 °F (0 - 40 °C) Humidity 10 - 80 % RH
External Dimensions** (W x D x H)	18.5 x 17.5 x 13.4 in. (468 x 444 x 339 mm)
Weight**	40 lbs. (18 kg)
Accessories	CD-ROM: Device driver, Operation manual, Installation manual, Control data sheet, Image Capture Plus software, SIS®/ TWAIN driver software, User utility software, Quick Scan Pro (DEMO) Installation manual, Power cord, Roller cleaning paper, Shading paper, USB cable (2.4 m) & Blower
Options	Roller exchange kit KV-SS039
	Roller cleaning paper KV-SS03
	Imprinter unit (Pre) KV-SS014
	Ink cartridge KV-SS021

Optional Flatbed Scanner KV-SS080 Specifications

Scanning Type	Flatbed
Scanning Method	CCD
Scanning Resolution	100 - 600 dpi (1 dpi step)
Scanning Speed** Letter size 200 dpi	3.3 sec. (Binary and Color)
Page Size	Maximum 8.5 x 11.7 in. (216 x 297 mm)
Interface	USB 2.0
Power Requirement	AC 100 - 240 V, 50/60 Hz
Power Consumption	Scanning 0.35 A (100 - 120 V), 0.2 A (200 - 240 V)
	Standby 0.25 A (100 - 120 V), 0.15 A (200 - 240 V)
	Sleep mode 3.5 W or less (100 - 120 V, 200 - 240 V)
Operating Environment	Temperature 59 - 86 °F (15 - 30 °C) Humidity 30 - 80 % RH
Storage Environment	Temperature 32 - 95 °F (0 - 35 °C) Humidity 10 - 80 % RH
Dimensions** (W x D x H)	11.3 x 20.4 x 3.3 in. (287 x 518 x 83.5 mm)
Weight**	7.5 lbs. (3.4 kg)
Accessories	CD-ROM: Operating manual AC adaptor, Power cord, USB cable

** The scanning speed differs depending on the host computer, the operating system, the application, the measuring method, the quantity of data in the image, and the paper type. The scanning speed depends on a measuring method of Panasonic.
** *Weight in pounds* of paper represents the weight of 500 sheets (17 x 22 in., 432 x 559 mm).
*Scan quality cannot be guaranteed for documents with a non-standard size.
** Dimensions and weights are approximate.

Dimensions

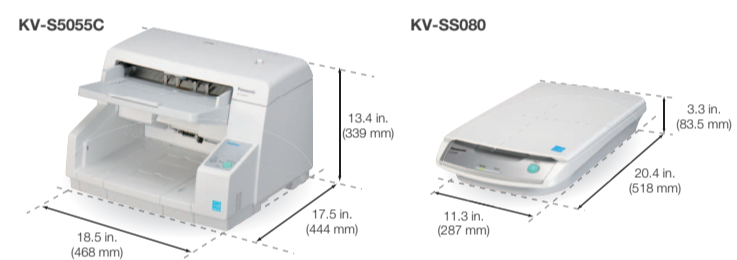

Roller exchange kit KV-SS039

Roller cleaning paper KV-SS03

Imprinter unit (Pre) KV-SS014

Ink cartridge KV-SS021



As an ENERGY STAR® Partner, Panasonic has determined that this product meets the ENERGY STAR guidelines for energy efficiency.

Windows® and Windows Vista® are either registered trademarks or trademarks of Microsoft Corporation in the United States and/or other countries. ENERGY STAR® and the ENERGY STAR certification marks are registered US marks. ISIS® and Quick Scan are registered trademarks or trademarks of EMC Corporation in the United States and other countries. All other brand or product names are the property of their respective holders. Design and specifications are subject to change without notice.

Panasonic

Panasonic System Networks Company of America
Three Panasonic Way, Secaucus, NJ 07094
For more information or to find a local dealer, visit panasonic.com/scanners

Bottom



ToughFeed Innovative Paper Feed Mechanism

- Stapled Document Detection
- Ultrasonic Double-Feed Detection
- Superior Roller Mechanisms

- Mixed Document Feeding
- Long Paper Mode
- 90 ppm / 180 ipm*
- Letter, Landscape, 200 dpi, Binary/Color
- High-Volume, 200-page ADF
- Self Cleaning Functions
- Ionizer NEW
- Scanning Glass Cleaning Brush NEW



This product is designed to reduce hazardous chemical substances along with the RoHS directive. MG-C535US

Boost Your Business Efficiency with a Ledger-Size, High-Speed Scanner

The fast 90-ppm* scan speed and 200-page Automatic Document Feeder are ideal for both large-volume scanning and dispersed input. ToughFeed, Panasonic's unique paper feed mechanism, also helps to minimize damage to important documents and ensures more precise feeding.



* Letter, Landscape, 200 dpi, Binary/Color.

ToughFeed Innovative Paper Feed Mechanism

Stapled Document Detection Preventing Damage to the Scanning Glass

Multiple sensors are used to detect various types of stapled documents, and to immediately stop the scanner when stapling is detected. This minimizes damage to both the document and the optical glass.

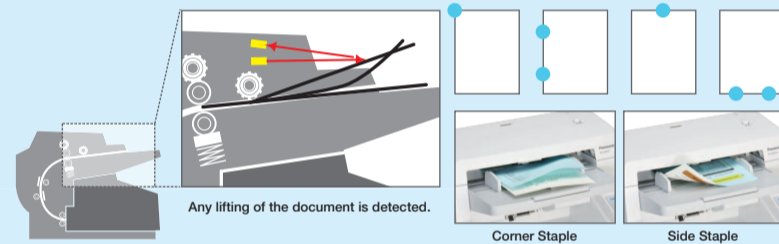

Staples are quickly and accurately detected, to minimize damage to the optical glass and the document.

Ultrasonic Double-Feed Detection Accurate Scanning

The KV-S5055C is equipped with an ultrasonic sensor, which accurately detects double-feeding even when scanning documents of various thicknesses. When detected, the ultrasonic sensor prevents double-feeding by immediately stopping the scanning process.

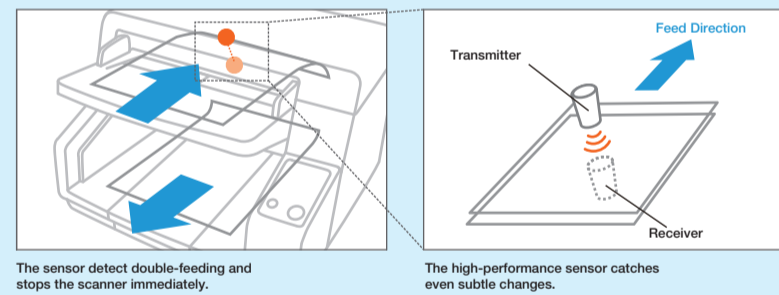

The sensor detect double-feeding and stops the scanner immediately.

The high-performance sensor catches even subtle changes.

Superior Roller Mechanisms Precise Feeding

The paper feed rollers separate from the paper each time a sheet is fed, so the tendency to double-feed caused by the paper feed roller pressure is reduced, even when feeding paper of different thicknesses. Any paper sliding is also detected and the double feed prevention roller pressure is adjusted to prevent the paper from slipping and jamming.

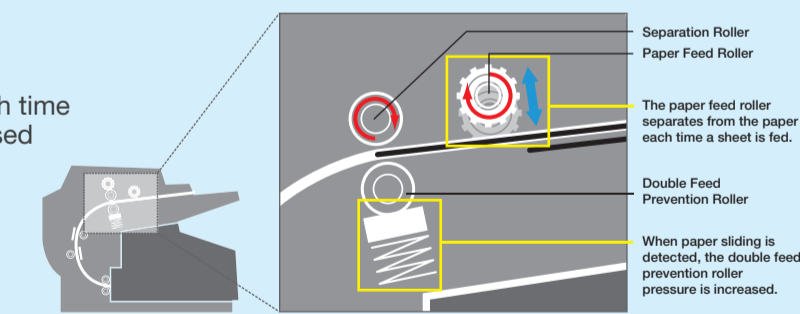

Separation Roller
Paper Feed Roller

The paper feed roller separates from the paper each time a sheet is fed.

Double Feed Prevention Roller

When paper sliding is detected, the double feed prevention roller pressure is increased.

Double Feed Skip (DFS) Key **NEW**

Should a scan operation stop due to the detection of double-feeding, simply press the DFS key to resume scanning. This is convenient when you don't want scanning to stop due to documents with things like receipts or sticky notes attached, or envelopes.

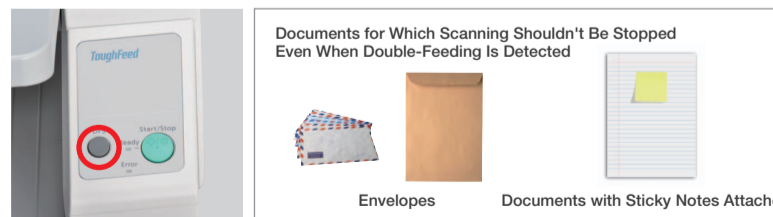

Documents for Which Scanning Shouldn't Be Stopped Even When Double-Feeding is Detected

Envelopes

Documents with Sticky Notes Attached

Image Capture Plus Enables Versatile Image Processing

Image Capture Plus is an application that transfers image data scanned by a Panasonic high-speed document scanner to a PC in the form of an image file. This software lets you edit scanned pages (switch pages, delete pages, etc.) intuitively using thumbnail images. It also allows you to make various settings to facilitate complex scanning processes and serves as a powerful tool for efficiently processing routine business work, such as filing.

Intuitive Operation

Scanned images can be displayed page by page in a thumbnail list. Pages can be easily moved and their positions switched by dragging and dropping the thumbnails of the pages.

Moving pages within a document

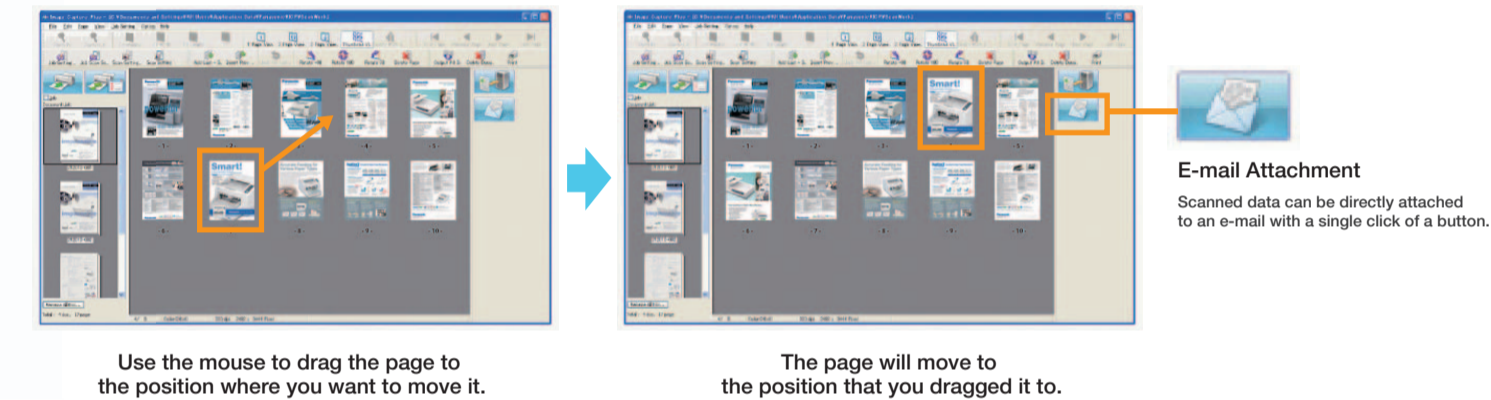

Use the mouse to drag the page to the position where you want to move it.

The page will move to the position that you dragged it to.

E-mail Attachment

Scanned data can be directly attached to an e-mail with a single click of a button.

Easy-to-Use Data Formats

Images can be saved in various data formats, such as PDF, JPEG, TIFF and Bitmap. Scanned data can be moved and saved in a selected folder all at once. Plus, PDF data and text-searchable data can be generated.

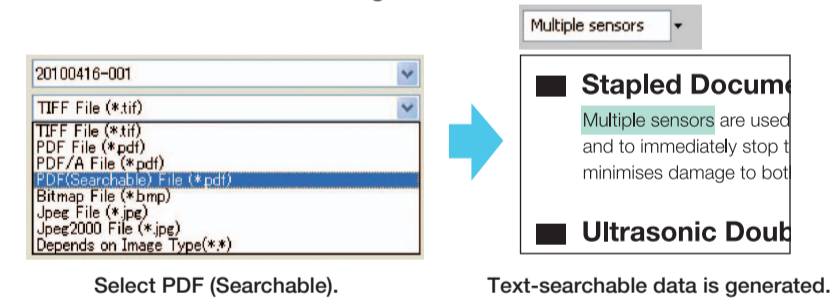

Select PDF (Searchable).

Text-searchable data is generated.

PreScan

In the preview window, you can confirm what the scanned image will look like under the current scan settings. You can make fine adjustments to brightness, contrast and other parameters while looking at the final result, and then save the desired scan settings. This boosts work efficiency by preventing wasted scans.

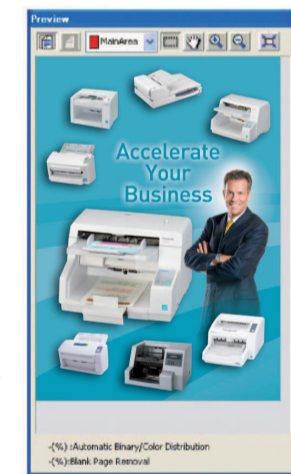

A Wealth of Image Processing Functions

Automatic Image Orientation

No more worries about the document's direction. Even when documents are set in different directions, this function detects the direction of the scanned text in documents and automatically rotates it into the correct direction.

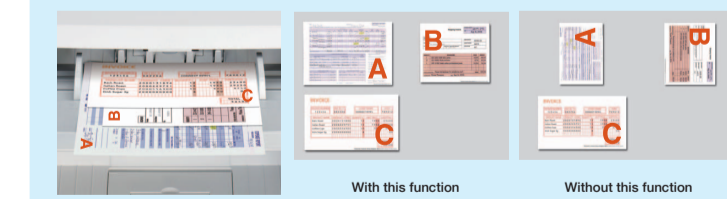

With this function

Without this function

Automatic Binary/ Color Distinction

No more need to pre-sort documents. Automatic Binary/ Color Distinction allows the scanner to recognize color and black and white pages. This feature reduces scan to file size while promoting a more efficient scanning process.

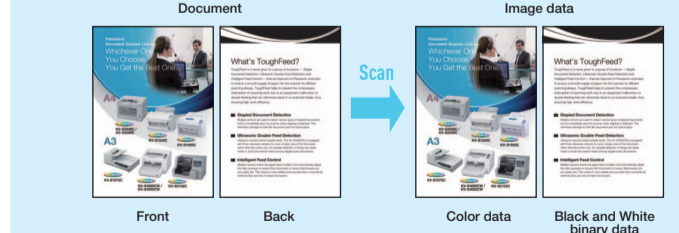

Color data

Black and White binary data

Double Exposure Two-in-one convenience

Double Exposure automatically scans then saves two-sided documents into a single-page file. It is highly effective for documents printed on both sides, such as checks, stock certificates, post cards, and business cards.

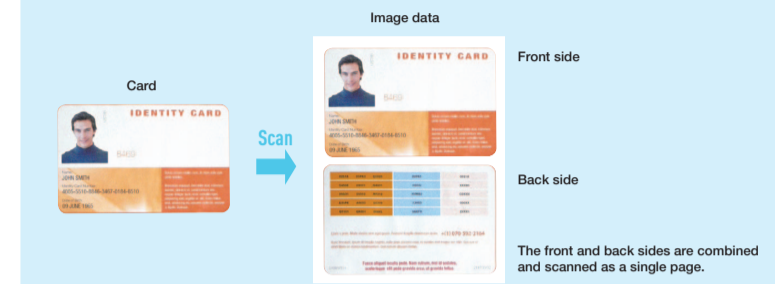

The front and back sides are combined and scanned as a single page.

Blank Page Removal You can convert only the desired pages into electronic form

When scanning a set of documents that contains both single-sided and double-sided sheets, this function automatically skips over the blank sides.

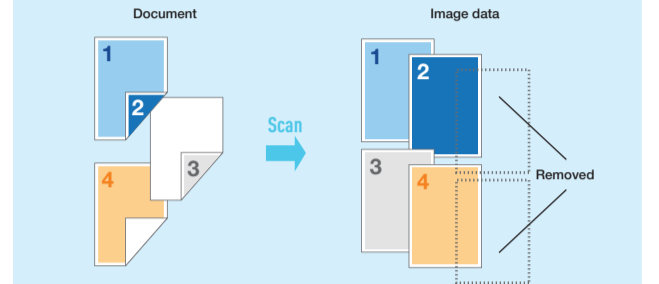

Removed

Automatic Crop and De-Skew Eliminates post-processing

When you scan documents of mixed sizes, the documents are automatically cropped and stored in the appropriate size. Also, skewed documents are automatically straightened when they are scanned.

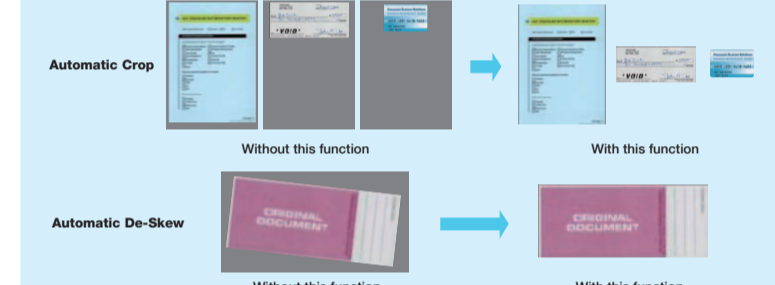

Without this function

With this function

Without this function

With this function

Multi Stream Single pass for dual output

The Multistream function enables a single scan to be saved as two separate formats simultaneously. For example the document will be saved in monochrome (B/W) for OCR and archival purposes, and saved as a full color image for short term on-screen retrieval.

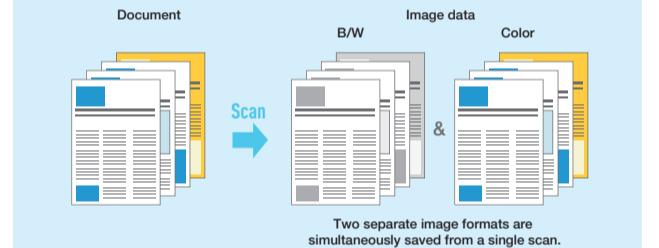

Two separate image formats are simultaneously saved from a single scan.

Dynamic Threshold Excellent readability and accuracy

With the Dynamic Threshold function, the background density and color are automatically detected section by section, and the scan setting (brightness control) is automatically adjusted to ensure sharp scanning of both text and images.

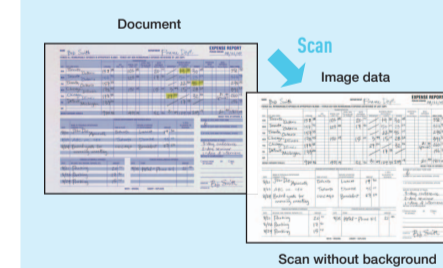

Scan without background

Multi Color Dropout Convenient for OCR processing

Any of up to three specific color ranges on the document can be selected as a dropout color. This function, when used in form processing applications, can greatly improve OCR performance and accuracy, resulting in increased productivity and potential cost savings.

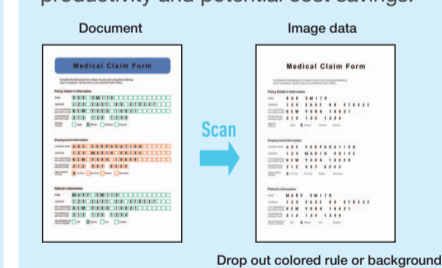

Drop out colored rule or background

Hole Removal Punch holes from the document are removed from the image

The Hole Removal function removes the punch hole marks from the scanned image. Round or square black shapes around the edges are replaced with the color closest to the document.



Hole Removed

Smooth Background No more fuzzy backgrounds

The Smooth Background function analyses images while scanning for background color content, and outputs the images with the background color solidified. This increases viewing clarity and reduces JPEG output file size.

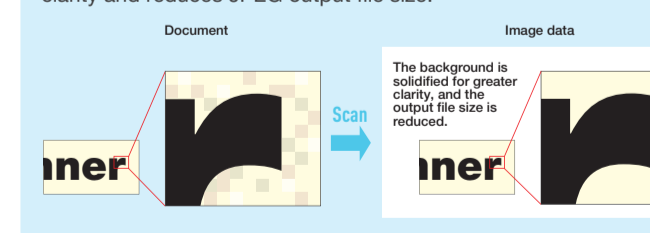

The background is solidified for greater clarity, and the output file size is reduced.

2-Page Separation Easily get the data you need from each page

2-Page Separation automatically divides the single image into two single sheets. Dividing scanned documents saves time and trouble because it makes complex editing operations unnecessary.

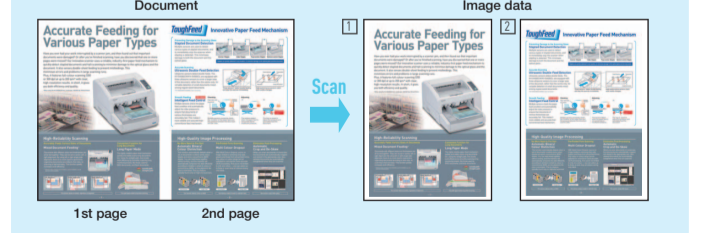

1st page

2nd page